



Dungsam Cement Corporation Ltd



འགྲུང་བསམ་རྩི་ས་ལས་འཛིན།
Dungsam Cement Corporation Limited
Nganglam; Pemagatshel



DUNGSAM CEMENT CORPORATION LIMITED

CONTRACT AGREEMENT

Maintenance of Workshop and CM Office

Terms and Conditions:

1. Any Bhutanese bidder holding contract license "Small Class" of "W3 Category" can be eligible to submit only one bid. The bidders are encouraged to visit the site in presence of DCCL representative to examine the site and obtain all necessary information for bidding purpose.
2. The bid submitted by bidder shall comprise of sealed and signed contract agreement, Form 1. Bid form, valid license and tax clearance certificate, bid security and priced Bill of Quantities sealed in an envelope and addressed to "P&MM Division Head, Dungsam Cement Corporation Limited". Omission of any of this document may subject to rejection of the bid.
3. The bid validity shall be till November 20, 2023. The last date for the submission of bid shall be 3:00PM October 20, 2023 and shall be opened on same date at 3:30PM in DCCL general conference hall, administrative block.
4. If DCCL determines that the contractor has engaged in corrupt, fraudulent, collusive, coercive or obstructive practices, then DCCL may terminate the contract immediately after giving a notice to the contractor.
5. The work must be taken up and completed in all respects within the time frame specified in work order and DCCL shall give possession of the site to the contractor. The duration of the contract shall be 60 days including the mobilization period. The contract duration shall not be extended if the quantity variation of item is within the 20% and the value to new items is within 20% of initial contract price.
6. The contract price shall be as specified in work order and quoted unit rate shall be applicable for any variations without limit. The prices bid by the contractor shall include all taxes and duties accordance to existing law and regulation. The contract price shall be paid only upon the completion of entire specified work within 30 days of the contractor claim and no advance payment shall be made. If





འགྲུབ་ལས་མ་རྒྱུ་སྐབས་འཛིན།
Dungsam Cement Corporation Limited
Nganglam; Pemagatshel



the contract is terminated due to fundamental breach of contract by the contractor, contractor shall be paid the value to work done and less the 20% of value of remaining work.

7. The bid shall be accompanied by bid security of Nu.29,000 valid till November 20, 2023 and successful bidder shall provide performance security of amount equivalent to 10% of contract price valid 30days beyond contract period. The securities shall be either in the form of Bank Guarantee, Demand Draft, cash warrant or cash issued by renowned Bhutanese financial institutions in the favor of CEO, DCCL.
8. If the contractor fails to attain completion of contract work within contract duration, DCCL shall deduct liquidity damages of amount equivalent to 0.2% of final contract price per day to the maximum of 10% after which contract shall be terminated immediately after giving a notice to the contractor.
9. The contractor shall be paid mobilization advance of 10% of bid price on substitution with security of equivalent amount.
10. The 10% deduction of retention money shall be applicable which shall be released on substitution with security of equivalent amount after completion of work. The retention money or substituted security shall be released after completion of defect liability period which shall be 6months from the date of completion.
11. The contractor shall be responsible for the safety of workers, security of equipment, environmental protection and remedying any defects therein throughout the execution of work.
12. DCCL reserves right to accept any bid or to reject any or all bids at any time prior to issue to work order, without thereby incurring any liability to the bidders.





འགྲུབ་བསམ་རྩི་ས་ལས་འཛིན།
Dungsam Cement Corporation Limited
Nganglam; Pemagatshel



Form 1: Bid Submission Form

Date: _____

Ref: NIT No: _____

To,

Dungsam Cement Corporation Limited,

Nganglam, Bhutan.

We, the undersigned declare that:

- Having examined all the Bidding documents, we offer to execute the maintenance of Office Partition and Maintenance of Workshop and CM Office in accordance with the contract agreement accompanying this Bid for the Contract Price of Nu__ (Ngultrum _____ in words).
- This Bid and your written work order shall constitute a binding Contract between us. We understand that you are not bound to accept the lowest or any bid you receive.
- We hereby confirm that this Bid complies with the Bid validity and Bid Security required by the Bidding Documents.
- We have no conflict of interest in submission of this Bid.
- Our firm has not been declared ineligible under the laws or official regulations of Bhutan.
- In case if we withdraw bid after opening for whatsoever reasons, we agree to the forfeiture of the Bid security.

Name of Signatory: _____

Name of Bidder: _____

Address: _____

Contact No: _____

Affix Legal Stamp
(With seal and signature)



Bill Of Quantities

SN	BSR Ref	Description	Unit	Quantity	Rate	Amount
Cement Mill & Packing Plant Office						
1	DD0017	Demolishing brick work including stacking useful materials & disposal of rubbish within 50m lead-In Cement Mortar.	Cum	2.25		
2	BW0012	Providing & laying Second-Class Brick work (250mm thick) in superstructure above plinth level -In cement mortar 1:4	Cum	0.63		
3	RC0007	Providing & laying in position reinforced cement concrete work in walls including the cost of centering, shuttering and reinforcement all complete as per the drawing-1:2:4 (1 cement : 2 sand : 4 graded crushed rock 20 mm nominal size)	Cum	0.47		
4	PL0021	Providing & laying 12mm cement plaster	Sqm	5.04		
5	A/R	Surface preparation removing by scraping, sand papering, including scratch repairs and Providing and applying one coat of acrylic putty	Sqm	1,456.00		
6	PT0042	Providing and applying Acrylic washable distemper, two coats on new work, including cement primer coat	Sqm	1,456.00		
7	GL0009	Providing & fixing white/ coloured glazed tiles 600mmX600mm in flooring laid on bed of 12mm thick cement mortar 1:3 finished with flush pointing in white cement.	Sqm	77.50		
8	GL0016	Providing & fixing white/ coloured Glazed tiles, 600 x 300 mm in Skirting where tiles are required to be cut finished with flush-pointing in white cement	Sqm	3.98		
7		Providing & fixing anodised Aluminium section for doors, windows, ventilators, partitions framing, false ceiling framing of specified sections including all accessories such as U-rubber gasket for fixing glass panes, weather strips or weather seals, roller, springs, etc complete (excluding the cost of glass panes or boards in case of partitions/doors/windows and ceiling boards in case of ceiling)				
7.1	SW0046	Openable Doors	Kg	49.57		
7.2	SW0047	Partition Framing	Kg	378.07		
8	SW0056	Providing and fixing plain glass panes on aluminium section complete (excluding the cost of aluminium frame & accessories)-5.5mm thick, plain glass	Sqm	44.06		
9	WW0122	Providing & fixing Cement Bonded Particle board (pre-laminated both sides for wall lining with necessary nails/screws etc. complete, excluding the cost of frame -10mm	Sqm	36.59		
10	WW0132	Providing & fixing Plywood lining with necessary nails etc. including beading complete (excluding cost of frame)-6 mm, commercial	Sqm	26.50		
Total Amount						



General Workshop

1	DD0017	Demolishing brick work including stacking useful materials & disposal of rubbish within 50m lead-In Cement Mortar	Cum	3.36		
2	DD0001	Demolishing cement concrete 1:3:6 & richer, including disposal of materials within 50m lead	Cum	2.05		
3	BW0021	Providing & laying Second-Class Half-brick Masonry (125 mm) in superstructure below floor 2 level-In cement mortar 1:4	Sqm	36.43		
4	CW0003	Providing and laying in position plain cement concrete excluding the cost of centering and shuttering - All work upto plinth level-1:2:4 (1 cement : 2 sand : 4 graded crushed rock 20 mm nominal size)	Cum	4.70		
5	A/R	Providing & laying in position reinforced cement concrete including cost of shuttering and excluding the cost of reinforcement - In Lintel and Counter Slab - 1:2:4 (1 cement : 2 sand : 4 graded crushed rock 20 mm nominal size)	Cum	0.37		
6	RC0083	Providing & fixing Thermo-Mechanically Treated reinforcement bar (Yield Strength 500 MPa) for R.C.C work including cutting, bending, binding and placing in position complete	Kg	81.93		
7	PL0021	Providing & laying 12mm cement plaster -C.M 1:4	Sqm	115.10		
8	GL0009	Providing & fixing white/ coloured glazed tiles 600mmX600mm in flooring laid on bed of 12mm thick cement mortar 1:3 finished with flush pointing in white cement.	Sqm	95.03		
9	GL0001	Providing & fixing white/ coloured Glazed tiles, 600 x 300 mm in Walls finished with flush-pointing in white cement	Sqm	115.10		
10	GL0016	Providing & fixing white/ coloured Glazed tiles, 600 x 300 mm in Skirting where tiles are required to be cut finished with flush-pointing in white cement	Sqm	10.00		
11	FL0175	Providing and laying Pre-Polished/ Polished Granite of approved quality and source in flooring using necessary cement bedding in C.M. 1:4 upto 20 mm thick average cement slurry for fixing the tiles with required slopes, curing, cleaning, filling the joints with pigments of similar colour and at all levels with all leads and lifts etc. complete as per directions of site in-charge and as per pattern required -18mm Thick granite stone flooring over 18mm thick base of cement mortar 1:4	Sqm	1.42		
12	P10002	Providing & fixing G.I. pipes including G.I. fittings & clamps & repair walls -20mm	m	5.00		
13	P10001	Providing & fixing G.I. pipes including G.I. fittings & clamps & repair walls -15mm	m	7.00		
14	P10041	Providing & fixing Indian-type vitreous china w.c squatting pan, including 100 mm H.C.I.P or S trap, 10 lit low level vitreous china cistern & fittings, repair walls -580mm, white Orissa-model	Each	4.00		
15	A/R	Providing & fixing white vitreous china undercounter wash basin 605mmX470mm, including 15mm C.P. brass pillar taps, 15mm C.P Angle Valve with connection pipe, c.p. chain & rubber plug, 32mm c.p brass waste, 32mm dia. trap & union, repair walls	Each	2.00		
16	P10208	Providing & fixing c.p. brass bibcock -15mm, long body, c.p. knob	Each	4.00		
17	P10277	Providing & fixing soap dish -Recessed, ceramic, 200x100 mm	Each	1.00		

18	PO0372	Providing & fixing P.V.C soil waste and vent pipes, single or double socketed, including pipe clip complete (excluding the cost of PVC fittings) -110mm	m	20.00		
19	PO0370	Providing & fixing P.V.C soil waste and vent pipes, single or double socketed, including pipe clip complete (excluding the cost of PVC fittings)-75mm	m	9.00		
20	PO0417	Providing & fixing P.V.C door bend -110mm	Each	4.00		
21	PO0405	Providing & fixing P.V.C plain bend	Each	8.00		
22	PO0437	Providing & fixing P.V.C Single Tee plain	Each	8.00		
23	A/R	Providing and fixing of Gypsum plaster false ceiling board (600mmX600mmX12mm) including providing and fixing of anodised aluminium section for false ceiling framing of specified sections including all connection accessories complete as per Drawing and engineer concerned approval.	Sqm	94.43		
24	A/R	Surface preparation removing by scraping, sand papering, including scratch repairs and Providing and applying one coat of acrylic putty	Sqm	192.50		
25	PT0042	Providing and applying Acrylic washable distemper, two coats on new work, including cement primer coat	Sqm	192.50		
Total Amount						
Grand Total						



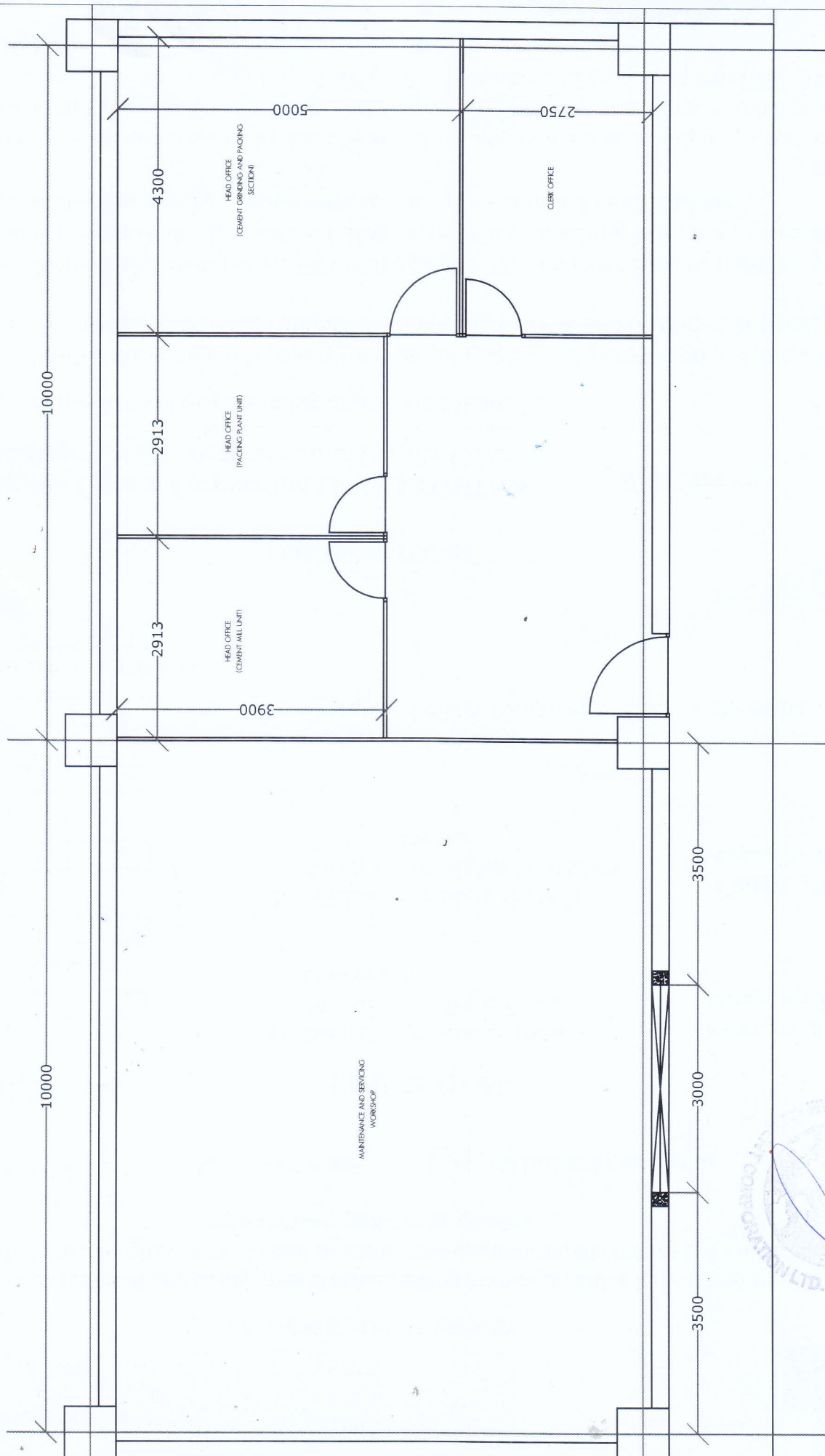

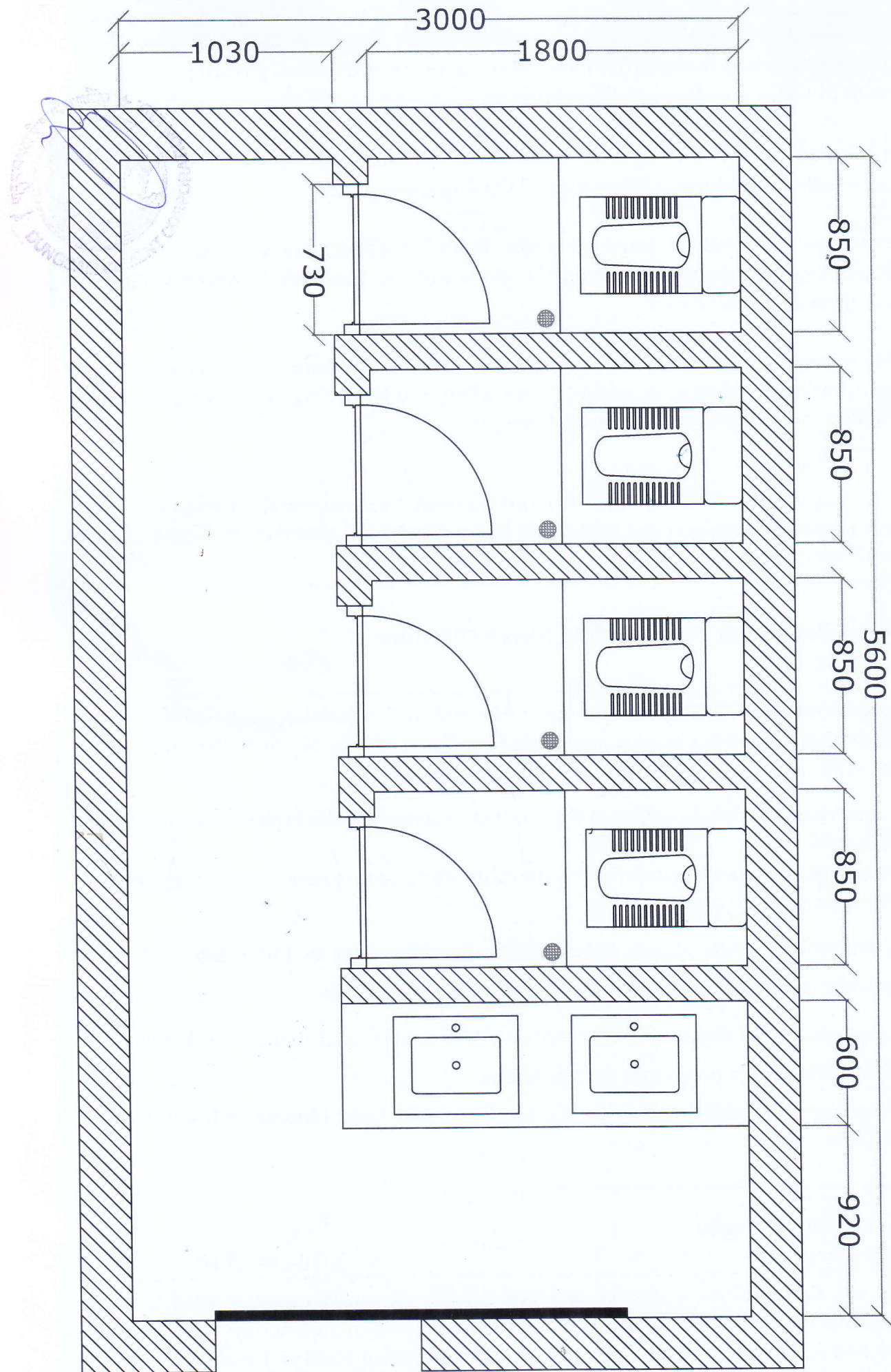

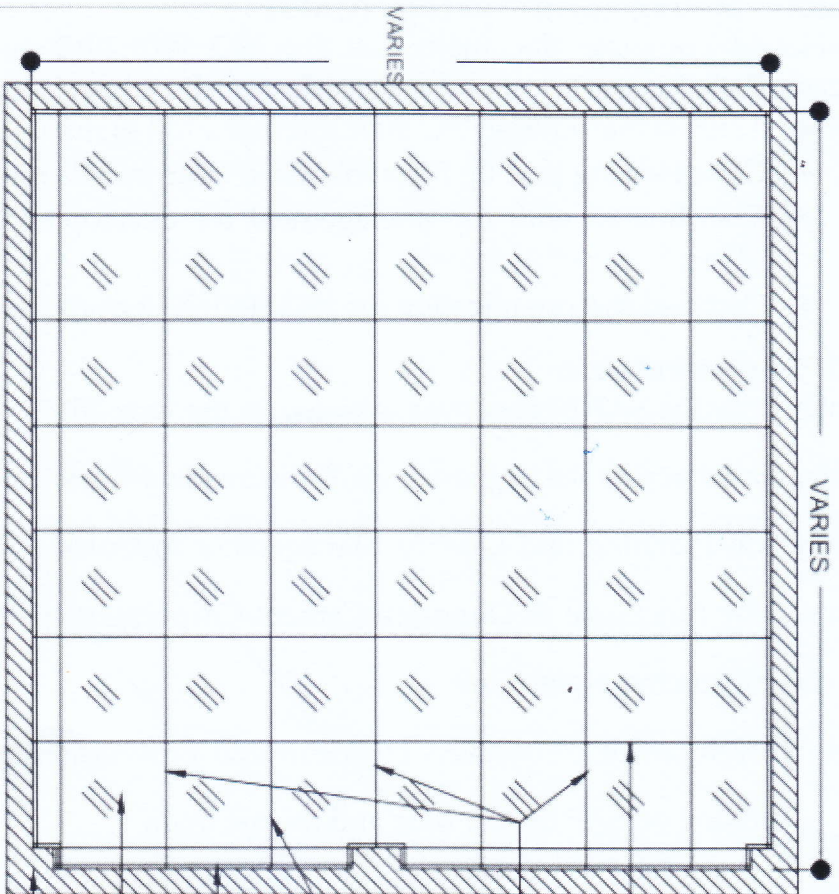

- CROSS RUNNER
ANODISED ALUMINIUM T (24X38X0.28)
- MAIN RUNNER
ANODISED ALUMINIUM T (24X38X0.28)
(should be hand with steel thread on steel chord)
- CROSS RUNNER
ANODISED ALUMINIUM T (24X38X0.28)
- L WALL ANGLE
ANODISED ALUMINIUM L (24X24X0.28)
- PLAIN GYPSUM FALSE CEILING
600MMX600MM
- EXISTING BRICK WALL

FALSE CEILING LAYOUT PLAN

